

S1 Section
Scale 1:100

TOILET BLOCK/BOOKING OFFICES/SACCO OFFICES/SECURITY & REVENUE

Window List						
Quantity	1	2	4	16	29	29
View from Side Opposite to Opening Side						
M.s cased with fixed expanded metal screen, (no panes)	M.s cased with fixed glass pane window	M.s cased with 300mm fixed pv glass pane window	M.s cased with 300mm high top hung glass pane opening and a 300mm fixed expanded metal screen below	M.s cased with 300mm fixed pv glass pane window	M.s cased with 300mm fixed pv glass pane window	M.s cased with 300mm fixed pv glass pane window
ID	W3	W2	W1	W3	W4	W5
Height	0.600	1.200	1.200	0.600	1.000	1.000
Width	0.750	0.600	0.750	0.800	1.200	1.200
Sill/Header Value	1.80	1.20	1.20	1.80	1.20	1.20

TOILET BLOCK/BOOKING OFFICES/SACCO OFFICES/SECURITY & REVENUE

Door List					
Quantity	1	1	3	9	29
2D Symbol					
View from Side Opposite to Opening Side					
ID	D3	D3	D1	D2	D4
Width	0.800	0.800	0.900	0.800	0.900
Height	2.000	2.100	2.400	2.000	2.400

TOILET BLOCK/BOOKING OFFICES/SACCO OFFICES/SECURITY & REVENUE

Door List				
Quantity	1	1	3	9
2D Symbol				
View from Side Opposite to Opening Side				
ID	D3	D3	D1	D2
Width	0.800	0.800	0.900	0.800
Height	2.000	2.100	2.400	2.000

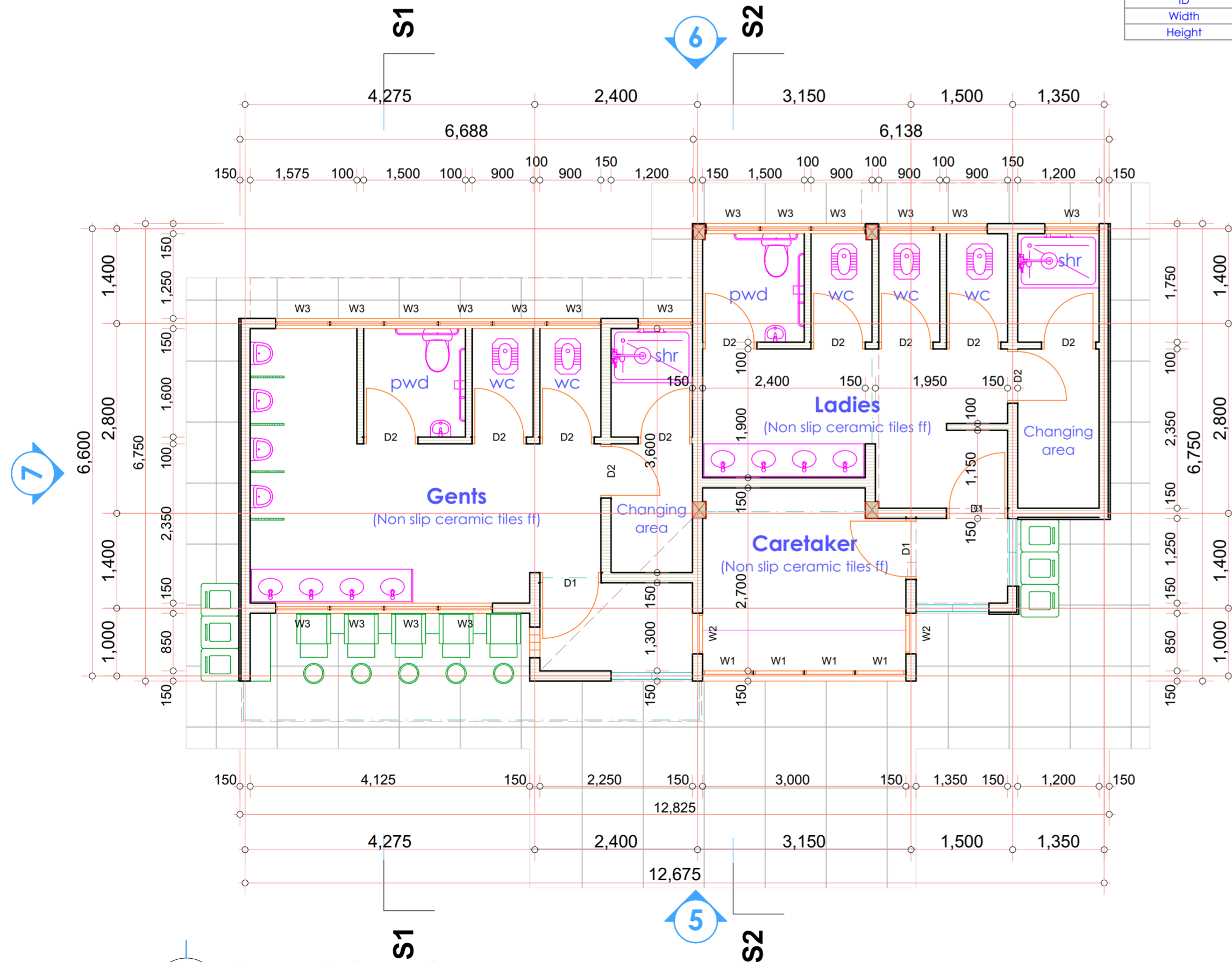

1 Ground Floor Plan
Scale 1:100 (Development Concept = 68.21sqm)

GENERAL NOTES:

- All dimensions to be checked on site before commencement of any work. Use figured dimensions only. Any discrepancies should be reported to the Architect immediately.
- All dimensions are in millimetres unless otherwise specified.
- P.V denotes permanent vent.
- Metal gutters & down pipe to suite.
- All windows & doors to schedule.
- All internal fittings to approval.

CIVIL WORKS:

- All soils under slabs and around external foundations to be treated for termite control.
- All soils on cut embankments to be stabilised. Slope not to exceed the natural angle of repose.
- All slabs at ground level to be poured over 1000 gauge polythene sheeting on 50mm stone blinding on hardcore.

STRUCTURAL WORKS:

- Refer to structural Engineers details for all r.c works.
- Foundation depth to be determined on site to structural Engineer's approval.
- All adjacent r.c work and masonry walls to be tied with strap irons at every course.

MECHANICAL WORKS:

- All sanitary fittings, doors, windows and lifts to schedules.
- All plumbing and drainage to comply with city council's specifications.
- All service ducts to be accessible from every floor.

1. FLOOR FINISHES

- lime
- coral rag
- lime plaster
- 300 X 300 X 10mm non slip ceramic tiles.
- coconut fibre
- wood parquet
- wood sliding medium
- 20mm thick random cut mazeras stones
- 200 X 65 X 20mm mvule wood blocks in approved pattern laid with adhesive
- 20mm lime mortar
- 40mm screed smooth finish(steel float).
- 300 X 300 X 40mm porcelain floor tiles.
- 30mm oak parquet flooring in approved pattern on 32mm 1:4 cement sand screed.

2. WALL FINISHES

- 1:3 mortar finished in smooth cement screed painted to architects approval
- 300 x 300 x 10mm thick ceramic tiles to 2400mm above finished floor level 3 coats matte paint to cornice.
- sharp sand
- lime mortar
- 12mm lime plaster finish with glaze coat on render backing to approval.
- 300 x 300 x 10mm mosaic tiles.
- Moulded mvule timber wall panelling upto 1200mm above finished floor level exposed random cut coral stone to picture rail emulsion paint to cornice.

3. CEILING FINISHES

- Unpainted water proofed rough cast lime plaster finish
- 450mm x 450mm suspended gypsum board acoustic ceiling panels
- 150mm x 45mm anti-termite boriti poles on lime fill soffit alternating with plastered ceiling strip at 300mm spacing
- Mvule timber strips T&G

4. SKIRTING FINISHES

- 300mmx100mmx10mm thick ceramic tiles
- 10mm cement mortar on 25mm thick cement screed
- 150mm high polished in-situ terrazzo
- 100mmx25mm pre-cast concrete tiles
- 150mm X 20mm mvule wood on plugged sand coated with polyurethane clear lacquer finish.

PROJECT TITLE: Proposed Bus Park at Nyamasaria

CLIENT: County Government of Kisumu - City of Kisumu

DRAWING TITLE:

DRAWING SCALE: AS SHOWN

STATUS: OUTLINE PROPOSALS DRAWINGS

REVISIONS

Nº	DESCRIPTION	DATE	COMMENT

PROGRAMME

KENYA URBAN SURPORT PROGRAMME (KUSP)



ARCHITECT

DIRECTORATE OF HOUSING & URBAN DEVELOPMENT
P.O BOX 821-40100
KISUMU.

PLOT LR. NUMBER: KISUMU/ KASULE/.....

DRAWN BY: Nyamita P. **CHECKED BY:** Arch. Steve O. GOME [A685] **SHEET NUMBER:** 01