

County Government of
Kisumu



City of Kisumu

DEVELOPMENT OF WASTE MANAGEMENT STATION

DRAWINGS

November, 2021

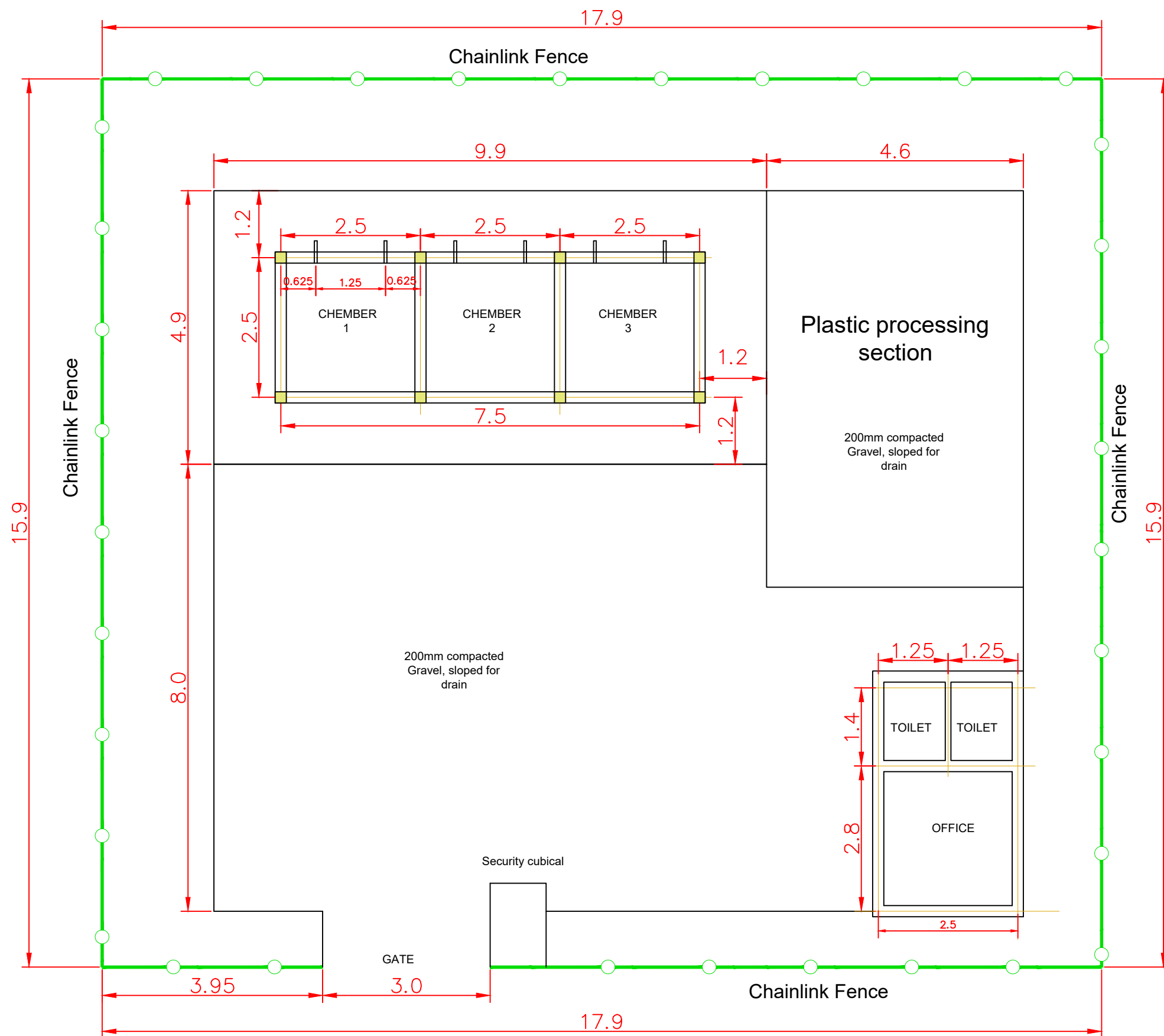

GENERAL LAYOUT

GENERAL NOTES
 1.This drawing is to be read in conjunction other contract documents.
 2.The contractor shall check all dimensions on site . Any errors or commissions shall be reported to the engineer before the work commence

WORKMANSHIP
 1.All concrete work shall be in accordance with S8110/CP114
 2.All reinforced concrete to be mechanically vibrated

STRUCTURAL STEEL
 1.To conform with requirements of British standard 449 part 2, 1969
 2.Main structural steel work to comply with grade 43; 50; &55

APPROVED BY: S.G.

DRAWN BY: P.A.

DESIGN BY: P.A.

CLIENT:
 City of Kisumu
 P.O. Box 105 - 40100, Kisumu

PROJECT:
DEVELOPMENT OF WASTE MANAGEMENT STATION IN KISUMU CITY

GENERAL LAYOUT	
DRAWING NO: CoK/WMT/01	SHEET NO: 1/1
SCALE: 1:40	DATE: NOVEMBER 2021

Sorting Chambers

ROOF NOTES
 Pitch -25 degrees
 Approved gauge 28 pre painted roofing sheets on 50x50mm tim. purlins on 50x50x3mm RHS Rafters and wall plates mounted on 75x75x3mm RHS

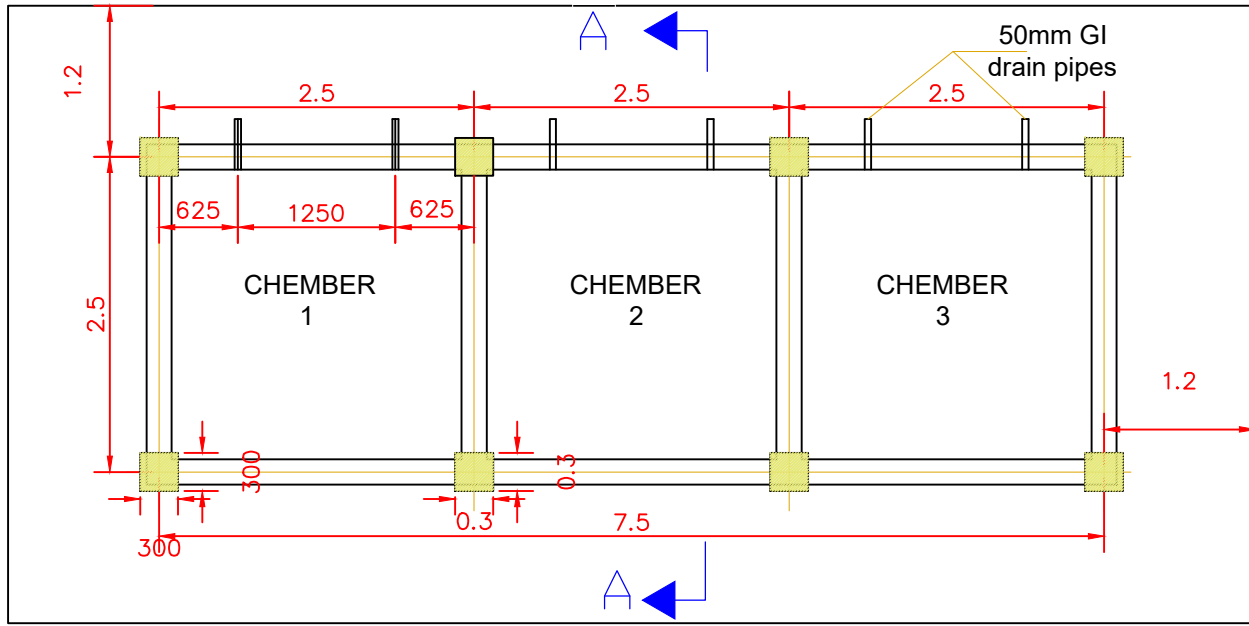

PLAN

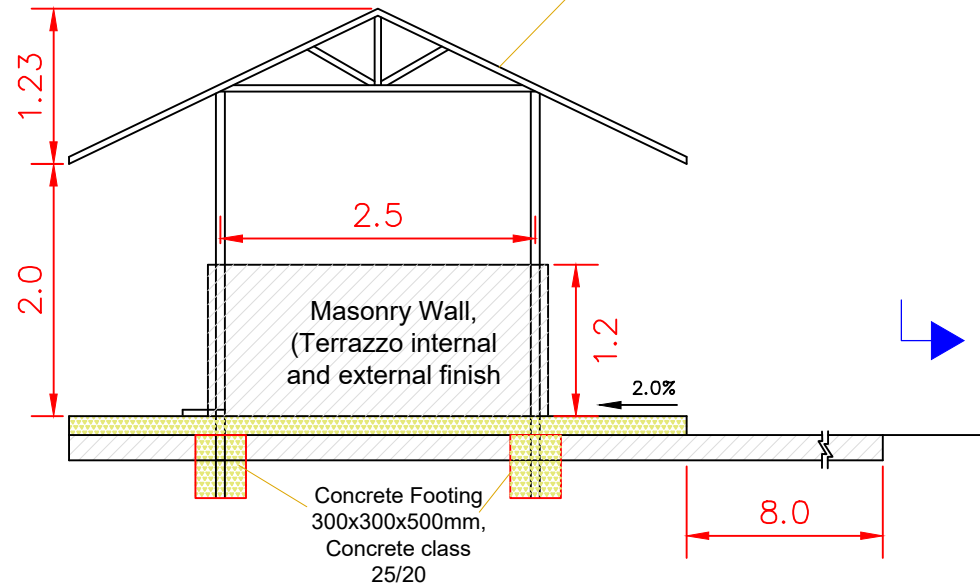

SECTION A-A

Office and Toilet

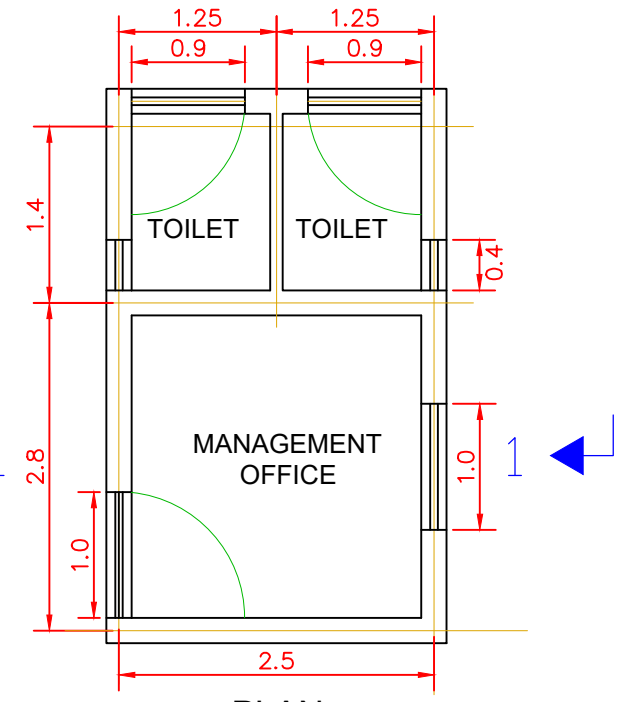

PLAN

ROOF NOTES
 Pitch -25 degrees
 Approved gauge 28 pre painted roofing sheets on 50x50mm tim. purlins on 50x50x3mm RHS Rafters and wall plates mounted on 75x75x3mm RHS

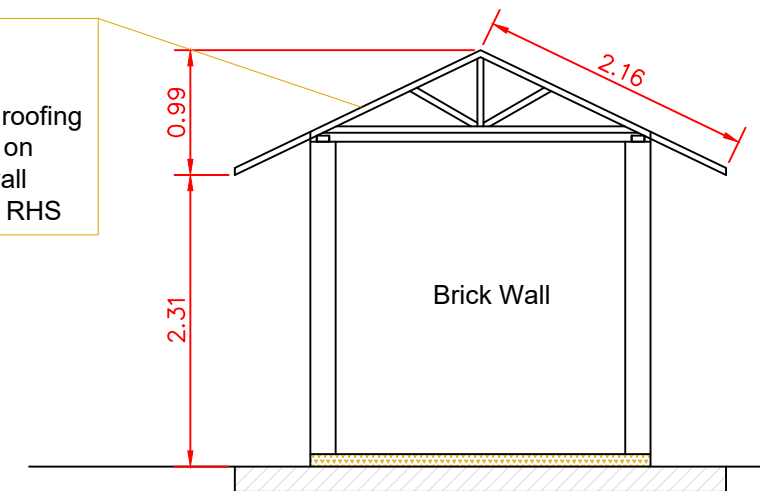

SECTION 1-1

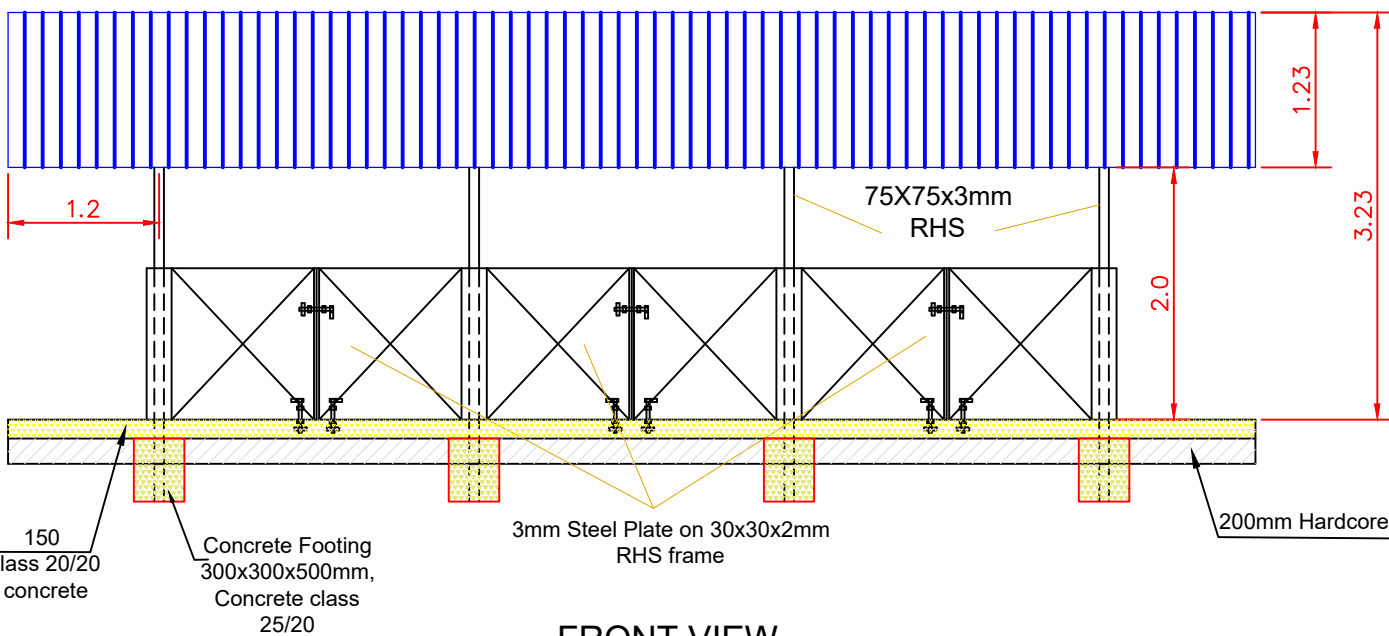

FRONT VIEW

APPROVED BY: S.G.

DRAWN BY: P.A.

DESIGN BY: P.A.

CLIENT:
 City of Kisumu
 P.O. Box 105 - 40100, Kisumu

PROJECT:
DEVELOPMENT OF WASTE MANAGEMENT STATION IN KISUMU CITY

BUILDINGS DETAILS

DRAWING NO: CoK/WMT/02

SHEET NO: 1/1

SCALE: 1:40

DATE: NOVEMBER 2021

NOTES ABOUT THE STEEL MEMBERS
 Steel pillars = Ø100mm, thickness = 4mm Min.
 Gate frame steel members = 60mm x 60mm x 2mm Min.
 Vertical and diagonal steel members = 20mm x 20mm x 2mm Min.
 Distance between the vertical steel members = 135mm C/C
 All the steel members must be galvanised

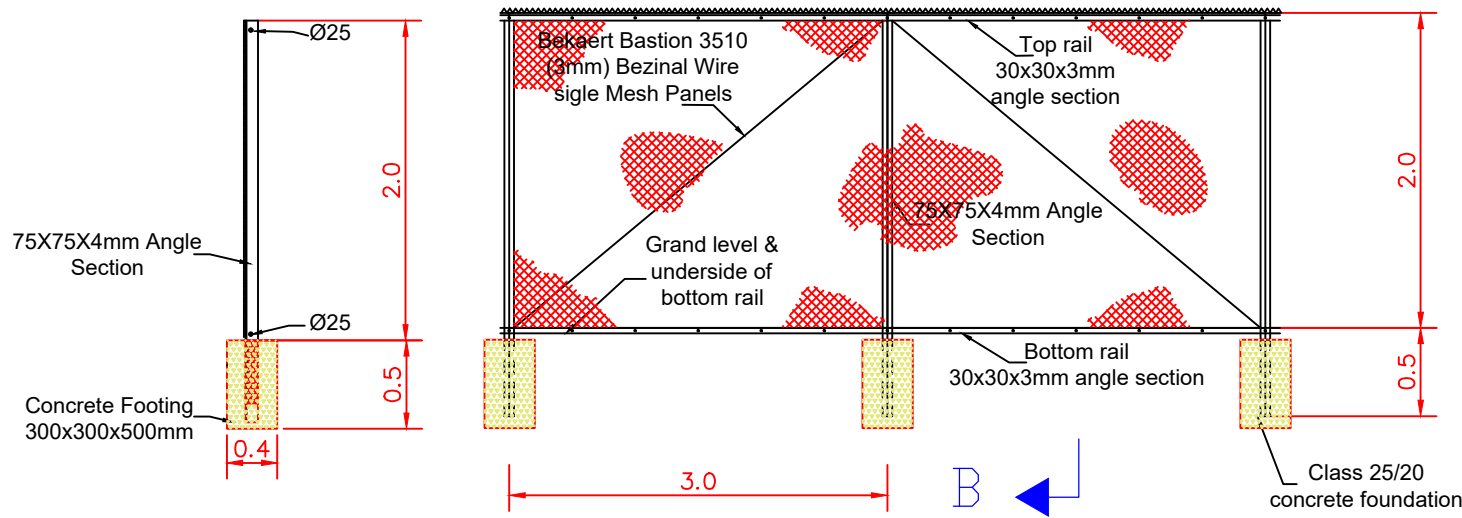

SECTION B-B

FRONTVIEW CHAIN LINK

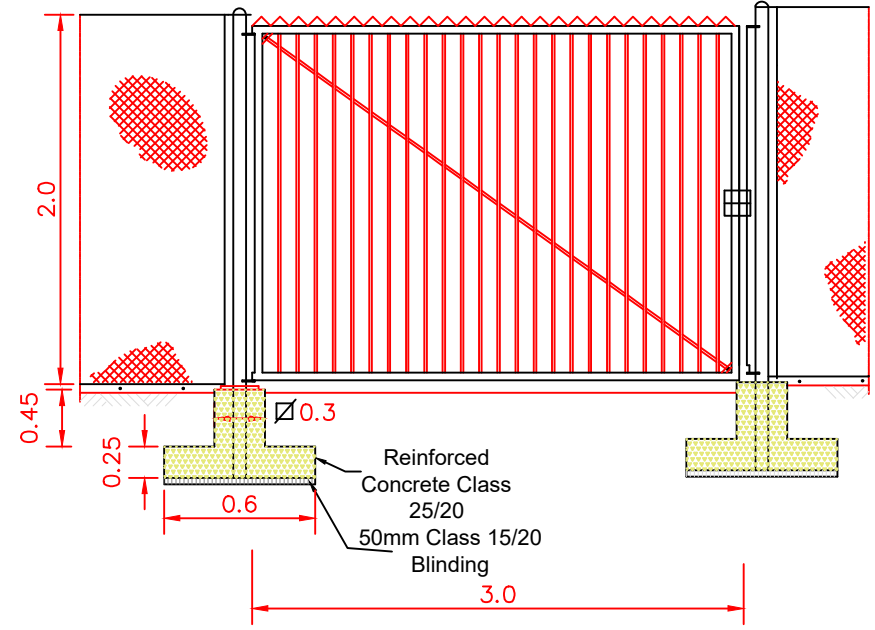

GATE

APPROVED BY: S.G.

DRAWN BY P.A.

DESIGN BY: P.A.

CLIENT:
 City of Kisumu
 P.O. Box 105 - 40100, Kisumu

PROJECT:
DEVELOPMENT OF WASTE MANAGEMENT STATION IN KISUMU CITY

FENCE AND GATE DETAILS	
DRAWING NO: CoK/WMT/03	SHEET NO: 1/1
SCALE: 1:40	DATE: NOVEMBER 2021